

Burlington Installation Corporation
WI200 / WF200
Foot Controls
for
Case Skid Steer Loaders
410, 420, 430, 440

Installation Instructions and
Bill of Materials

Parts or Questions
Contact

Burlington Installation
Phone: 316-943-2515
Fax: 316-943-4448

BIC

FOOT CONTROLS FOR - 410,420,430 & 440

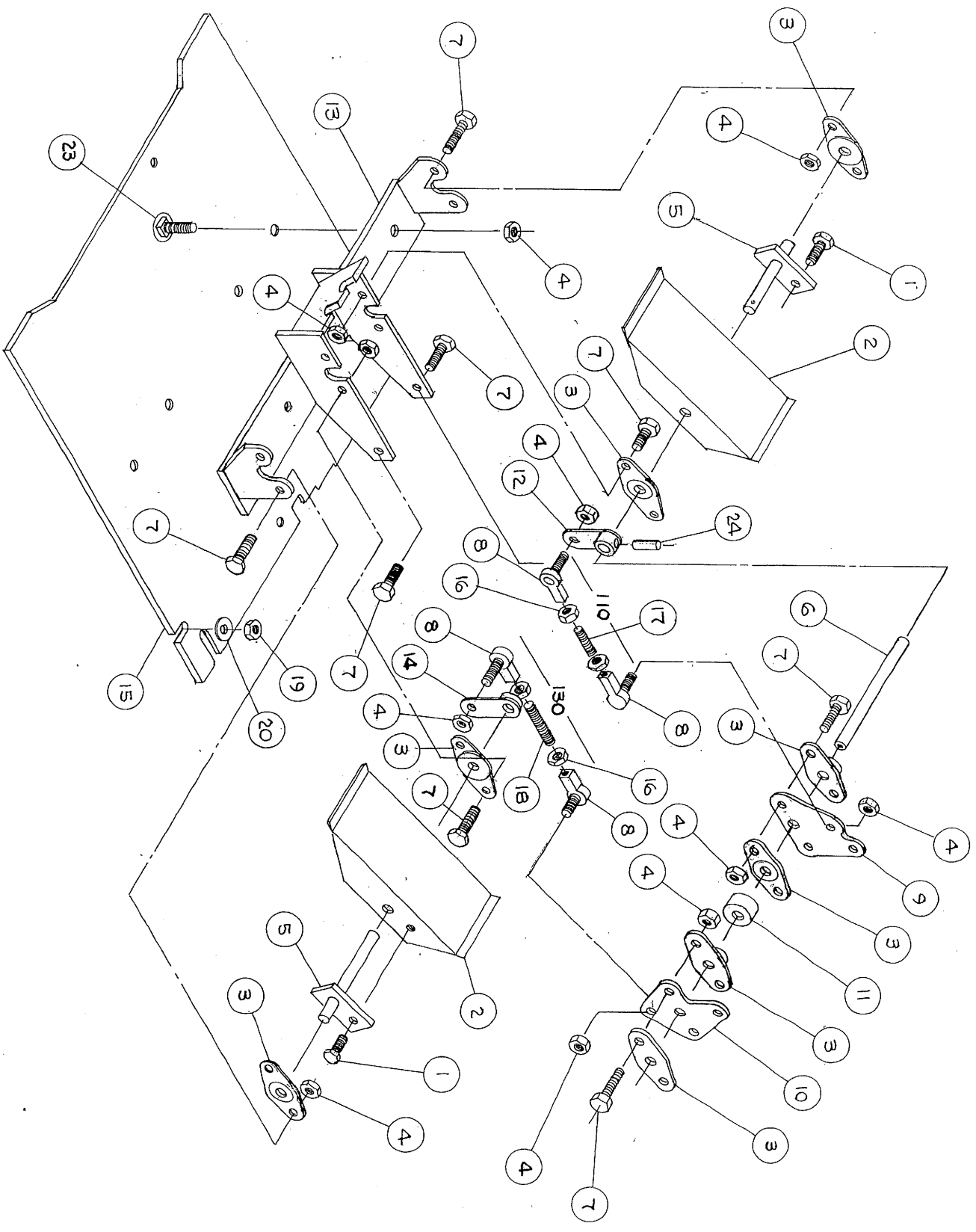

FOOT CONTROL - 410, 420, 430 + 440

ITEM	P/N	QTY	NOUN	DESCRIPTION	REV
1	50A-0606	2	BOLT	3/8-16UNC X 3/4	
2	9622462	2	PEDAL		
3	86567251	8	BEARING		
4	30C-06	23	NUT	3/8-16UNC NYLOCK	
5	C21506	2	SHAFT/W	PEDAL	
6	C21481	1	SHAFT		
7	50A-0608	14	BOLT	3/8-16UNC X 1"	
8	230425A1	5	ROD END	BALL	
9	C21473	1	LEVER		
10	C21472	1	LEVER		
11	C21493	1	SPACER		
12	C21502	1	LEVER/W	LH	
13	C21479	1	FOOT CONTROL/W		
14	C21503	1	LEVER/W	RH	
15	C21492	1	FLOORPLATE/W		
16	31A-06	4	NUT	3/8-24UNF	
17	C21490	1	ROD	LH	
18	C21491	1	ROD	RH	
19	30A-05	2	NUT	5/16-18UNC	
20	14C-05	2	WASHER	5/16 FLAT	
21	86521667	1	DECAL	DUMP RH SIDE	
22	86521665	1	DECAL	LIFT LH SIDE	
23	C21510	4	BOLT	3/8-16UNC X 1 1/4 CARRIAGE	
24	C21511	2	PIN	7/32 X 1"	

FOOT CONTROLS FOR 410, 420, 430 & 440

COVER ON HELL PLATE

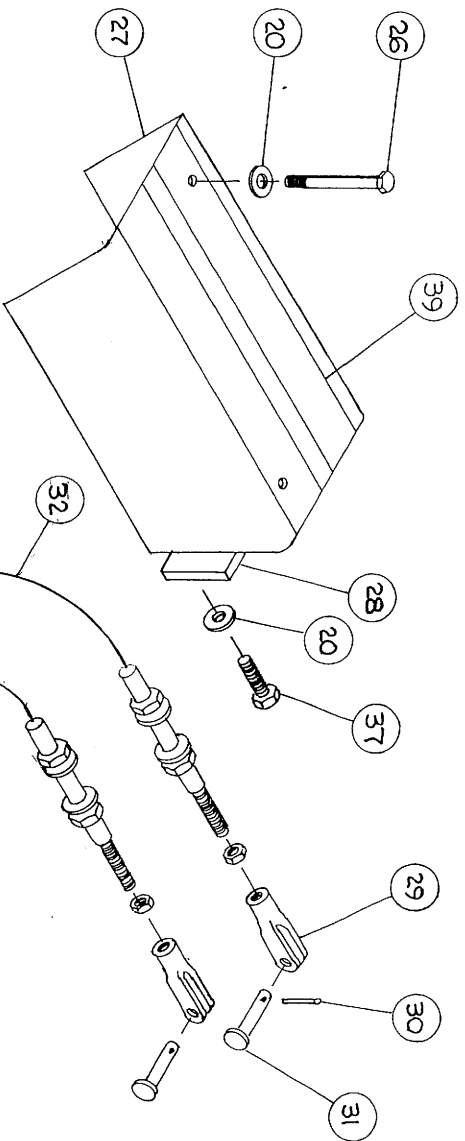
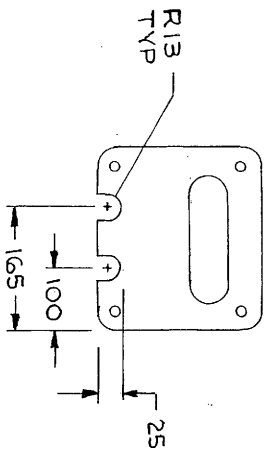

CONNECT TO LEVER ON RH HANDLE FOR BUCKET CONTROLS

USE IF UNIT HAS CABLE OPERATED AUX HYD

SEE PAGE FOR ASSEMBLY OF CABLE ON VALVE

RIGHT HAND CONSOLE

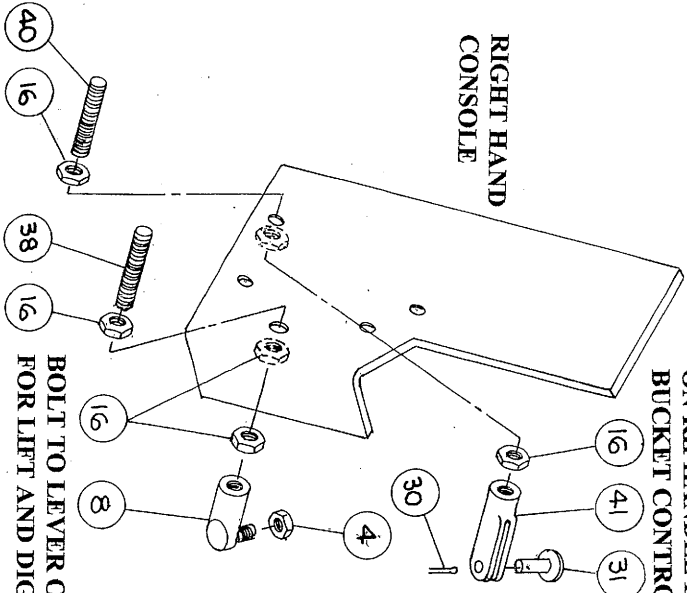

BOLT TO LEVER ON RH HANDLE FOR LIFT AND DIG FUNCTION

USE IF UNIT HAS ELECTRIC HYDRAULICS

FOOT CONTROL 410, 420, 430 & 440

ITEM	P/N	QTY	NOUN	DESCRIPTION	REV
4	30C-06	2	NUT	3/8-16UNC NYLOCK	C
8	230425A	1	ROD END	BALL	
16	31A-06	7	NUT	3/8-24UNF	BC
19	C21556	1	ROD	AUX HYD	C
20	14C-05	4	WASHER	5/16 FLAT	
21	50A-0628	1	BOLT	3/8-16UNC x 3 1/2" LG	C
22	D144606	1	BALLJOINT		C
25					C
26	50A-0548	2	BOLT	5/16-18UNC x 6"	
27	C21455	1	COVER/W		
28	C21482	1	PLATE		
29	28031477	2	YOKE END	FEMALE	
30	432-816	4	COTTER PIN	1/8 x 1	B
31	427-6106	4	CLEVIS PIN		B
32	C21496	1	CABLE	LIFT	
33	C21495	1	CABLE	BUCKET	
34	50D-0424	2	BOLT	1/4-20UNC x 3" SOCKET HD	
35	50D-0420	2	BOLT	1/4-20UNC x 2 1/2" SOCKET HD	
36	C21497	2	KIT	CABLE ENTRY	
37	50A-0508	2	BOLT	5/16-18UNC x 1"	C
38	C21494	1	ROD	CONTROL LOCK	
39	C21512	2	STRIP	SKID	
40	C21526	1	ROD	FOOT CONTROL	B
41	280377	1	YOKE END	FEMALE	B
42	87435550	1	SPACER		C
43	14C-06	2	WASHER	3/8" FLAT	C

Assembly of valve end of control cables.

1. Thread large nut and housing connector over end of cable to allow access to threads on end of cable (photo 1).
2. Thread small nut and spool connector until inside of connector is flush with end of cable and lock with nut (see photos 2 & 3).
3. Attach cable connector to valve spool using 13/16" (21mm) X 1/4" (6.35mm) pin.
4. Adjust housing connector to 1 5/16" dimension (photo 4).

