

Burlington Installation Corporation
C19617

Boom Guard
for
Case 580SL/SM Backhoe

Installation Instructions and
Bill of Materials

Parts or Questions
Contact
Burlington Installation
Phone: 316-943-2515
Fax: 316-943-4448

BIC BOOM GUARD / I - 580SL & 580SM

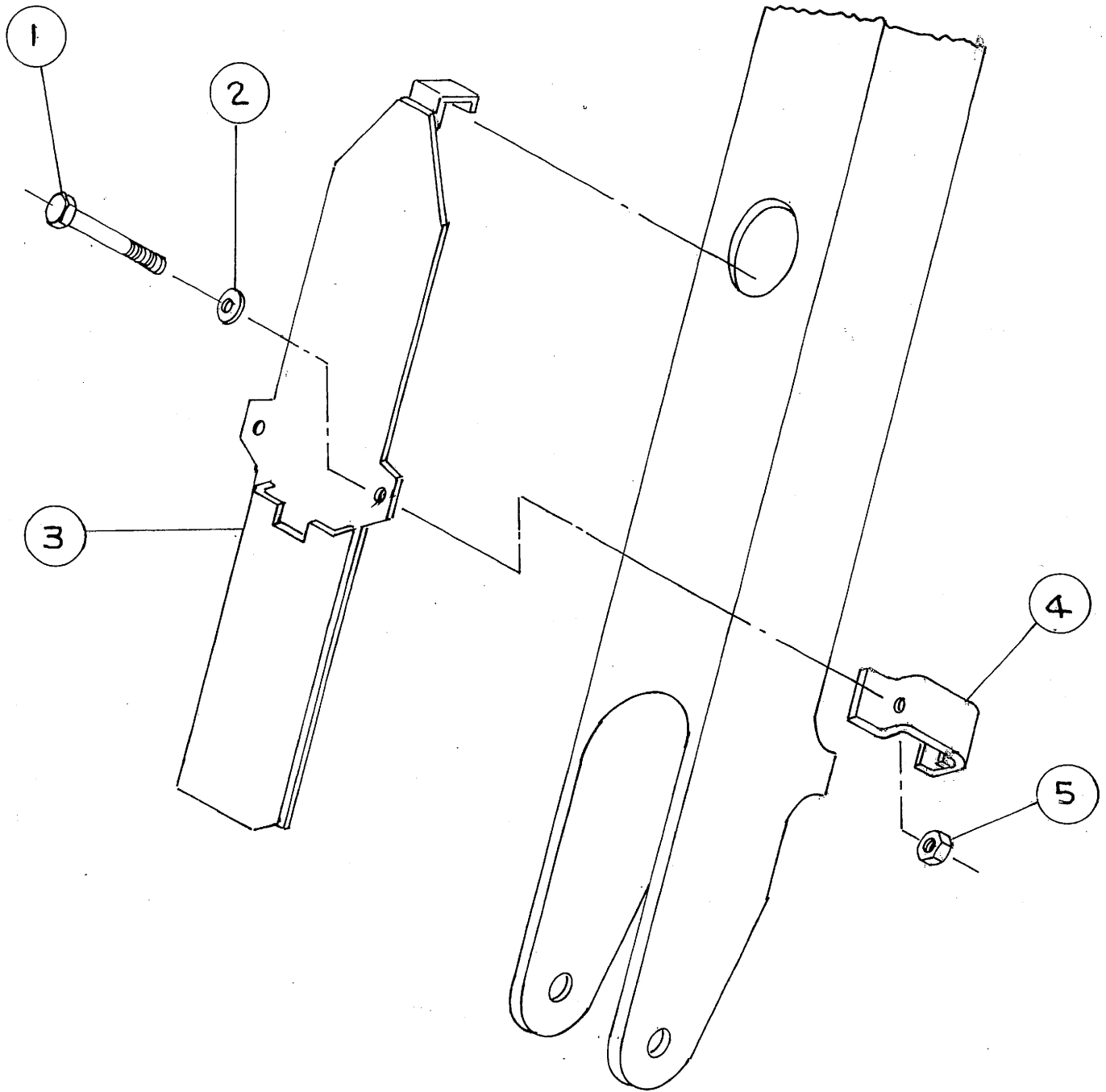

- GUARD / I - BOOM 580SL & 580SM
- | | | | |
|---|----------|-------------|---------------|
| 1 | 50A-1040 | 2 BOLT | 5/8-11 UNCx5" |
| 2 | 14C-10 | 2 WASHER | 5/8 FLAT |
| 3 | C20039 | 1 GUARD/W | BOOM |
| 4 | C20041 | 2 BRACKET/W | |
| 5 | 30C-10 | 2 NUT | 5/8 NYLOCK |